

**Para ordenar repuestos, sírvase llamar al distribuidor de Campbell Hausfeld más cercano a su domicilio**

Sírvase darnos la siguiente información:

- Número del modelo
- Número de serie (de haberlo)
- Descripción y número del repuesto según la lista de repuestos

Puede escribirnos a:

The Campbell Group / Attn: Parts Dept.  
100 Production Drive  
Harrison, OH 45030 USA

Nú. Ref.	Descripción	Repuestos para los Modelos:				Ctd.
		VT633500	EX840100 VT619504 VT627504 VT631402	VT632900		
1	Tanque	AR040000CG	AR040000CG	AR040000CG	1	
2	Llave de salida	D-1403	D-1403	D-1403	1	
3	Motor eléctrico	MC015402IP	MC015402IP	MC015402IP	1	
4	Chaveta	KE000903AV	KE000903AV	KE000903AV	1	
5	Tornillo de cabeza hex	ST016000AV	ST016000AV	ST016000AV	4	
6	Arandela	ST011200AV	ST011200AV	ST011200AV	4	
7	Tuerca de seguridad	ST146001AV	ST146001AV	ST146001AV	4	
8	Niple	ST070387AV	HF002401AV	HF002401AV	1	
9	Presostato	CW209300AJ	CW209300AJ	CW209300AJ	1	
10	Cordón del motor	EC012800AV	EC012800AV	EC012800AV	1	
11	Válvula de seguridad ASME	V-215105AV	V-215105AV	V-215105AV	1	
12	Enchufe	ST022500AV	ST022500AV	ST022500AV	1	
13	Manómetro	—	GA016700AV	GA016700AV	1	
14	Válvula de desfogue	CW210000AV	CW210000AV	CW210000AV	1	
15	Válvula de chequeo	CV221502AJ	CV221502AJ	CV221502AJ	1	
16	Tapa de contacto	ST085200AV	ST085200AV	ST085200AV	1	
17	Tubo de escape	VT043300AP	VT043300AP	VT043300AP	1	
18	Tuerca de compresión	ST033001AV	ST033001AV	ST033001AV	1	
19	Ajuste de empuje	ST081301AV	ST081301AV	ST081301AV	1	
20	Tubo de salida	ST117802AV	ST117802AV	ST117802AV	1	
21	Cabezal	VT470000KB	VT470000KB	VT470000KB	1	
22	Tapón del drenaje de aceite	ST022300AV	ST022300AV	ST022300AV	1	
23	Tapa del drenaje de aceite	ST150100AV	ST150100AV	ST150100AV	1	
24	Extensión del drenaje de aceite	ST083800AV	ST083800AV	ST083800AV	1	
25	Ensamblaje de compresión	ST018300AV	ST018300AV	ST018300AV	1	
26	Tornillo autorroscante	ST016500AV	ST016500AV	ST016500AV	4	
27	Banda	BT020400AV	BT020400AV	BT020400AV	1	
28	Volante	PU015900AV	PU015900AV	PU015900AV	1	
29	Chaveta	KE000900AV	KE000900AV	KE000900AV	1	
30	Tornillo	ST026200AV	ST026200AV	ST026200AV	1	
31	Polea	PU012600AV	PU012600AV	PU012600AV	1	
32	Tornillo de cabeza cuadrada	ST012200AV	ST012200AV	ST012200AV	1	
33	Guardacorrea plástico (atrás)	BG217902AV	BG217902AV	BG217902AV	1	
34	Tornillo	ST058502AV	ST058502AV	ST058502AV	1	
35	Guardacorrea plástico (frente)	BG217800AV	BG217800AV	BG217800AV	1	
36	Tornillo autorroscante	ST073269AV	ST073269AV	ST073269AV	1	
37	Tornillo autorroscante	ST073277AV	ST073277AV	ST073277AV	3	
38	Filtro alternante - diámetro del 5,08 cm (2")	WL012000AV	WL012000AV	ST073915AV	1	
	Filtro alternante - diámetro del 10,16 cm (4")	ST073920AV	ST073920AV	ST073920AV	1	
39	Elemento del filtro alternante - diámetro del 5,08 cm (2")	WL012300AV	WL012300AV	ST073916AV	1	
	Elemento del filtro alternante - diámetro del 10,16 cm (4")	ST073921AV	ST073921AV	ST073921AV	1	
40	▲ Juego de etiquetas de advertencias generales	DK630000AV	DK630000AV	DK630000AV	1	
41	▲ Etiqueta de advertencias para mover e instalar la unidad	DK364601AV	DK364601AV	DK364601AV	1	
42	▲ Reductor de orificio de inspección 5,08 cm x 19,1 mm (2" x 3/4")	PG201002AV	PG201002AV	PG201002AV	1	
	▲ Reductor de orificio de inspección 5,08 cm x 6,4 mm (2" x 1/4")	PG201004AV	PG201004AV	PG201004AV	1	
43	▲ Tornillo del relieve de tensión	ST209800AV	ST209800AV	ST209800AV	1	
44	▲ Relieve de tensión	CW209700AV	CW209700AV	CW209700AV	1	
45	▲ Anillo en o para el orificio de inspección	ST070190AV	ST070190AV	ST070190AV	2	
▲	No su muestra					

# Vertical Air Compressors Compresseurs d'Air Verticaux Compressores de Aire Verticales

**Replacement Parts List  
Liste de Pièces de Rechange  
Lista de Repuestos**

**VT619504, VT627504, EX840100,  
VT631402, VT632900, VT633500**

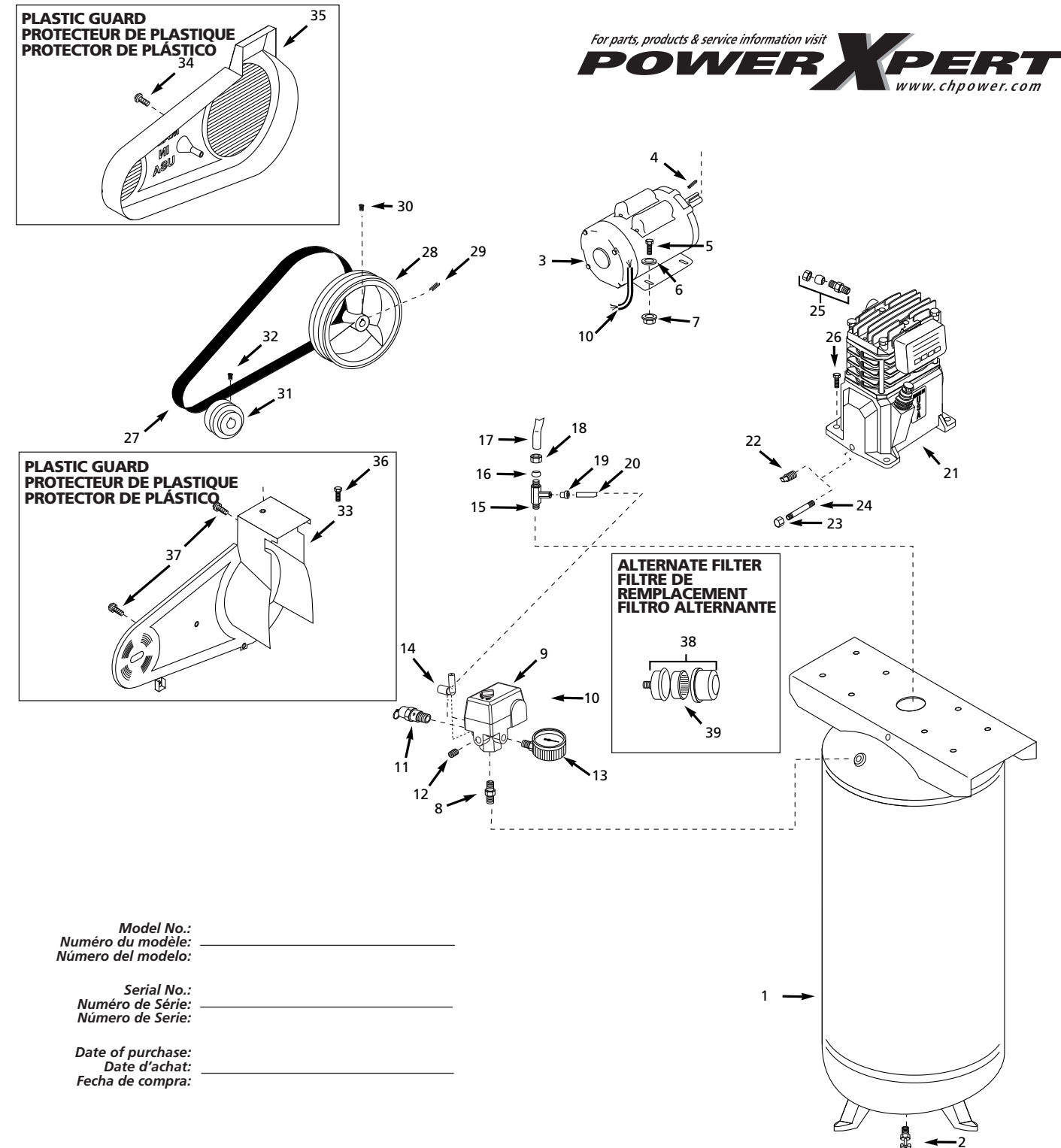

## For Replacement Parts, Call 1-800-543-6400

Please provide following information:

- Model number
- Serial number (if any)
- Part description and number as shown in parts list

Address parts correspondence to:

The Campbell Group / Attn: Parts Dept.  
100 Production Drive  
Harrison, OH 45030

Ref. No.	Description	Part Number for Models:			Qty.
		VT633500	EX840100 VT619504 VT627504 VT631402	VT632900	
1	Tank	AR040000CG	AR040000CG	AR040000CG	1
2	Drain cock	D-1403	D-1403	D-1403	1
3	Electric motor	MC015402IP	MC015402IP	MC015402IP	1
4	Key	KE000903AV	KE000903AV	KE000903AV	1
5	Hex head screw	ST016000AV	ST016000AV	ST016000AV	4
6	Washer	ST011200AV	ST011200AV	ST011200AV	4
7	Locknut	ST146001AV	ST146001AV	ST146001AV	4
8	Nipple	ST070387AV	HF002401AV	HF002401AV	1
9	Pressure switch	CW209300AJ	CW209300AJ	CW209300AJ	1
10	Motor cord	EC012800AV	EC012800AV	EC012800AV	1
11	ASME Safety valve	V-215105AV	V-215105AV	V-215105AV	1
12	Plug	ST022500AV	ST022500AV	ST022500AV	1
13	Gauge	—	GA016700AV	GA016700AV	1
14	Unloader valve	CW210000AV	CW210000AV	CW210000AV	1
15	Check valve	CV221502AJ	CV221502AJ	CV221502AJ	1
16	Ferrule	ST085200AV	ST085200AV	ST085200AV	1
17	Exhaust tube	VT043300AP	VT043300AP	VT043300AP	1
18	Compression nut	ST033001AV	ST033001AV	ST033001AV	1
19	Push-in fitting	ST081301AV	ST081301AV	ST081301AV	1
20	Unloader tube	ST117802AV	ST117802AV	ST117802AV	1
21	Pump	VT470000KB	VT470000KB	VT470000KB	1
22	Oil drain plug	ST022300AV	ST022300AV	ST022300AV	1
23	Oil drain cap	ST150100AV	ST150100AV	ST150100AV	1
24	Oil drain extension	ST083800AV	ST083800AV	ST083800AV	1
25	Compression assembly	ST018300AV	ST018300AV	ST018300AV	1
26	Self-tapping screw	ST016500AV	ST016500AV	ST016500AV	4
27	Belt	BT020400AV	BT020400AV	BT020400AV	1
28	Flywheel	PU015900AV	PU015900AV	PU015900AV	1
29	Key	KE000900AV	KE000900AV	KE000900AV	1
30	Setscrew	ST026200AV	ST026200AV	ST026200AV	1
31	Pulley	PU012600AV	PU012600AV	PU012600AV	1
32	Square hd set screw	ST012200AV	ST012200AV	ST012200AV	1
33	Plastic belt guard (back)	BG217902AV	BG217902AV	BG217902AV	1
34	Plascrew	ST058502AV	ST058502AV	ST058502AV	1
35	Plastic belt guard (front)	BG217800AV	BG217800AV	BG217800AV	1
36	Self-tapping screw	ST073269AV	ST073269AV	ST073269AV	1
37	Self-tapping screw	ST073277AV	ST073277AV	ST073277AV	3
38	Alternate filter - 2" diameter	WL012000AV	WL012000AV	ST073915AV	1
	Alternate filter - 4" diameter	ST073920AV	ST073920AV	ST073920AV	1
39	Alternate filter element - 2" diameter	WL012300AV	WL012300AV	ST073916AV	1
	Alternate filter element - 4" diameter	ST073921AV	ST073921AV	ST073921AV	1
40	▲ General warning decal set	DK630000AV	DK630000AV	DK630000AV	1
41	▲ Moving and mounting warning decal	DK364601AV	DK364601AV	DK364601AV	1
42	▲ Inspection port reducer 2" x 3/4"	PG201002AV	PG201002AV	PG201002AV	1
	▲ Inspection port reducer 2" x 1/4"	PG201004AV	PG201004AV	PG201004AV	1
43	▲ Strain relief screw	ST209800AV	ST209800AV	ST209800AV	1
44	▲ Strain relief	CW209700AV	CW209700AV	CW209700AV	1
45	▲ Inspection port o-ring	ST070190AV	ST070190AV	ST070190AV	2
▲	Not shown				

## Pour Pièces de Rechange, Appeler 1-800-543-6400

S'il vous plaît fournir l'information suivant:

- Numéro du modèle
- Numéro de série (s'il y en a un)
- Description de la pièce et son numéro sur la liste

Correspondance:

The Campbell Group / Attn: Parts Dept.  
100 Production Drive  
Harrison, OH 45030 USA

N°. Ref.	Description	Numéro de Piece pour Modèles:			Qté.
		VT633500	EX840100 VT619504 VT627504 VT631402	VT632900	
1	Réservoir	AR040000CG	AR040000CG	AR040000CG	1
2	Robinet de vidange	D-1403	D-1403	D-1403	1
3	Moteur électrique	MC015402IP	MC015402IP	MC015402IP	1
4	Clavette	KE000903AV	KE000903AV	KE000903AV	1
5	Vis à tête hexagonale	ST016000AV	ST016000AV	ST016000AV	4
6	Rondelle	ST011200AV	ST011200AV	ST011200AV	4
7	Écrou de serrage	ST146001AV	ST146001AV	ST146001AV	4
8	Raccord	ST070387AV	HF002401AV	HF002401AV	1
9	Manostat	CW209300AJ	CW209300AJ	CW209300AJ	1
10	Cordon du moteur	EC012800AV	EC012800AV	EC012800AV	1
11	Soupape de sûreté ASME	V-215105AV	V-215105AV	V-215105AV	1
12	Bouchon	ST022500AV	ST022500AV	ST022500AV	1
13	Jauge	—	GA016700AV	GA016700AV	1
14	Soupape de déchargement	CW210000AV	CW210000AV	CW210000AV	1
15	Clapet	CV221502AJ	CV221502AJ	CV221502AJ	1
16	Virole	ST085200AV	ST085200AV	ST085200AV	1
17	Tuyau d'échappement	VT043300AP	VT043300AP	VT043300AP	1
18	Écrou de compression	ST033001AV	ST033001AV	ST033001AV	1
19	Raccord enfichable	ST081301AV	ST081301AV	ST081301AV	1
20	Tuyau de déchargement	ST117802AV	ST117802AV	ST117802AV	1
21	Pompe	VT470000KB	VT470000KB	VT470000KB	1
22	Bouchon de vidage d'huile	ST022300AV	ST022300AV	ST022300AV	1
23	Capuchon de vidange d'huile	ST150100AV	ST150100AV	ST150100AV	1
24	Rallonge de vidange d'huile	ST083800AV	ST083800AV	ST083800AV	1
25	Assemblage de compression	ST018300AV	ST018300AV	ST018300AV	1
26	Vis autoforeuse	ST016500AV	ST016500AV	ST016500AV	4
27	Courroie	BT020400AV	BT020400AV	BT020400AV	1
28	Volant	PU015900AV	PU015900AV	PU015900AV	1
29	Clavette	KE000900AV	KE000900AV	KE000900AV	1
30	Vis de pression	ST026200AV	ST026200AV	ST026200AV	1
31	Poulie	PU012600AV	PU012600AV	PU012600AV	1
32	Vis de pression a tête carré	ST012200AV	ST012200AV	ST012200AV	1
33	Protège-courroie de plastique (arrière)	BG217902AV	BG217902AV	BG217902AV	1
34	Vis	ST058502AV	ST058502AV	ST058502AV	1
35	Protège-courroie de plastique (avant)	BG217800AV	BG217800AV	BG217800AV	1
36	Vis autoforeuse	ST073269AV	ST073269AV	ST073269AV	1
37	Vis autoforeuse	ST073277AV	ST073277AV	ST073277AV	3
38	Filtre de remplacement - diamètre de 2 po	WL012000AV	WL012000AV	ST073915AV	1
	Filtre de remplacement - diamètre de 4 po	ST073920AV	ST073920AV	ST073920AV	1
39	Élément du filtre de remplacement - diamètre de 2 po	WL012300AV	WL012300AV	ST073916AV	1
	Élément du filtre de remplacement - diamètre de 4 po	ST073921AV	ST073921AV	ST073921AV	1
40	▲ Ensemble de décalcomanies d'avertissement générales	DK630000AV	DK630000AV	DK630000AV	1
41	▲ Decalcomanie d'avertissement de déplacement et de montage	DK364601AV	DK364601AV	DK364601AV	1
42	▲ Raccord de réduction de porte inspection 2 po x 3/4 po	PG201002AV	PG201002AV	PG201002AV	1
	▲ Raccord de réduction de porte inspection 2 po x 1/4 po	PG201004AV	PG201004AV	PG201004AV	1
43	▲ Vis de soulagement de fatigue	ST209800AV	ST209800AV	ST209800AV	1
44	▲ Soulagement de fatigue	CW209700AV	CW209700AV	CW209700AV	1
45	▲ Joint torique de porte de inspection	ST070190AV	ST070190AV	ST070190AV	2
▲	Pas indiquée				